

# SHUTTER + LIGHT MONITOR

SLM-XS / SLM-XS-W / SLM-XS-WF

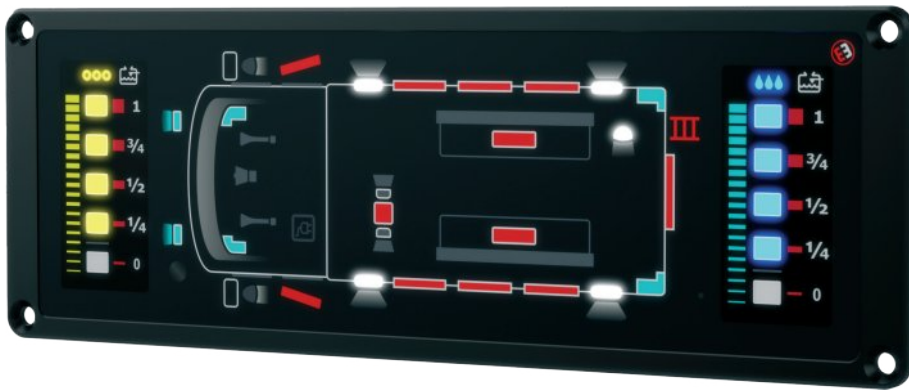

## KEY FEATURES

- + 22 Digital Inputs, positive or negative
- + Ambient Light Sensor
- + Colour LEDs
- + Integrated Warning Buzzer
- + Selectable Remote Water/Foam Tank Level Indicator
- + CAN Bus Communications

The **S&L Monitor** is designed to monitor open side lockers (roller shutters), roof boxes, ladder and displays the status of different kinds of emergency and other lights on special vehicles.

Key advantage: Integrated Water and Foam remote level indicator as optional feature. State of monitored devices will be indicated with LED warning lights in different colours.

Integrated buzzer can signalize raised light mast, open roof boxes and open ladder to draw special attention to the driver at the moment that the parking brake has been released.

Monitoring is provided through 22 digital inputs. Digital inputs are connected via uP to altogether 37 LED lights. Digital inputs can be connected to GND or +UBatt signal, to detect the status of connected lamps, shutters or other equipment. An integrated photo sensor detects the ambient light and automatically adjusts the LED intensity for day or night operation.

## SPECIFICATIONS

### POWER

**Supply Voltage** 8-30 V DC

**Current** 0.2 A maximum, no outputs active

**Electrical Protection** overvoltage, reverse polarity

### INTERFACES

**CAN** 1 x CAN

**CAN termination** configurable termination 120 ohm via DIP switch

### INPUTS

**Digital Input** 22 configurable-active low/high, levels 0 .. Ub

### MISCELLANEOUS

**Level Indication** Water and Foam level optional, remote type

**Indicator increments** 1/4

**Day/Night operation** automatic – integrated ambient light sensor

**LED indication** colour LED (white, blue, red, yellow)

### ENVIROMENT

**IP Class (IEC529)** front panel – IP65

**Temperature Range** storage -40° to +85°C (-40° to 185°F)  
operating -40° to +85°C (-40° to 185°F)

### ENCLOSURE

**Housing Material** aluminium-black coated

**Mounting** in-dash, with 4 screws M3 or 2.9 tapping screws

**Connector** Terminal block 4 way, 8 way and 14 way connector, 0,5 to 1,5 mm2 (AWG 28-16)

### SIZE & WEIGHT

**W x H x D** 174 x 60 x 15 mm without connector

**Weight** 0.2 kg

## DIMENSIONS

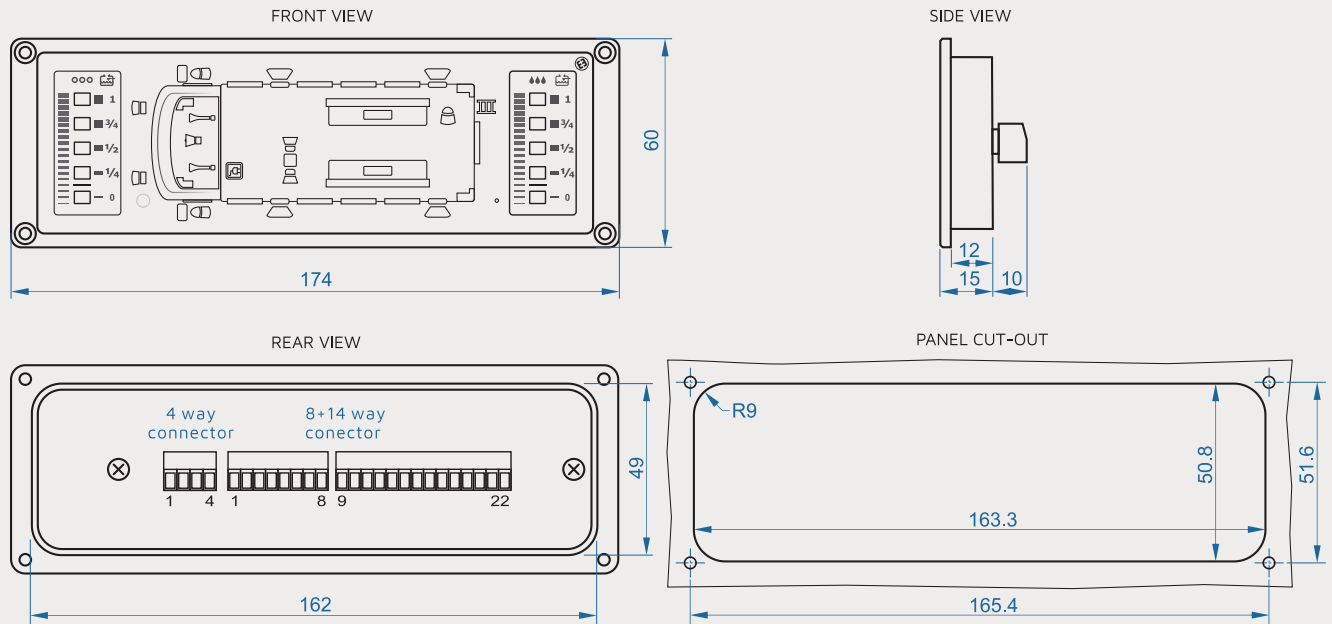

## CONNECTIONS

### CONNECTION TERMINAL BLOCK 4 WAY

**PIN** Description / wire colour

- |   |                  |
|---|------------------|
| 1 | BATTERY + ("15") |
| 2 | BATTERY -        |
| 3 | CAN L            |
| 4 | CAN H            |

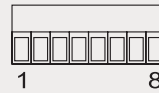

### CONNECTION TERMINAL BLOCK 8 WAY + 14 WAY

**PIN** Description / wire colour

- |      |                      |
|------|----------------------|
| 1-22 | INPUT (configurable) |
|------|----------------------|

## EXAMPLE OF DESIGN OPTIONS

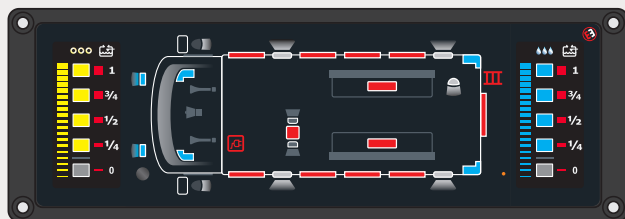

SLM-9S-WF

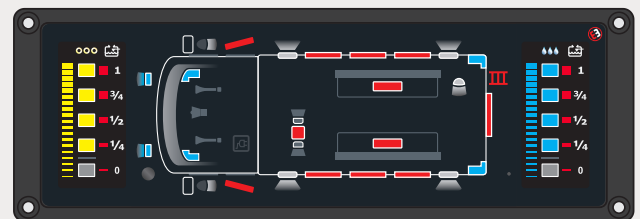

SLM-7S-WF

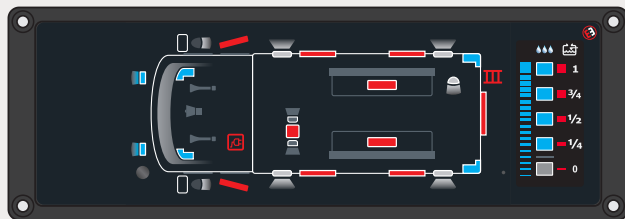

SLM-5S-W

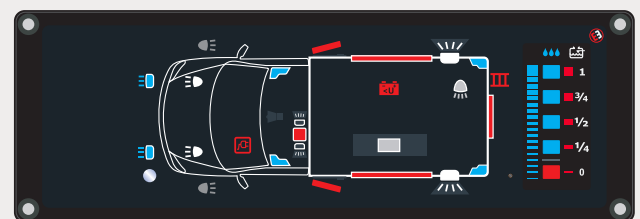

SLM-3S-W

## PRODUCT CODE

Remote Indicator - Small

Ordering code example:

S	L	M	-	7	S	-	W	F
---	---	---	---	---	---	---	---	---

**3S**: 3 SHUTTERS (2+1)  
**5S**: 5 SHUTTERS (2+2+1)  
**7S**: 7 SHUTTERS (3+3+1)  
**9S**: 10 SHUTTERS (4+4)

**W**: INTEGRATED WATER LEVEL INDICATOR

**F**: INTEGRATED FOAM LEVEL INDICATOR